

Riverhill Run 5K Course
 St. Florian, Alabama
 Lauderdale County
 Measured by Danny Michael and Gary House
 April 13, 2003

CERTIFIED AL03014JD

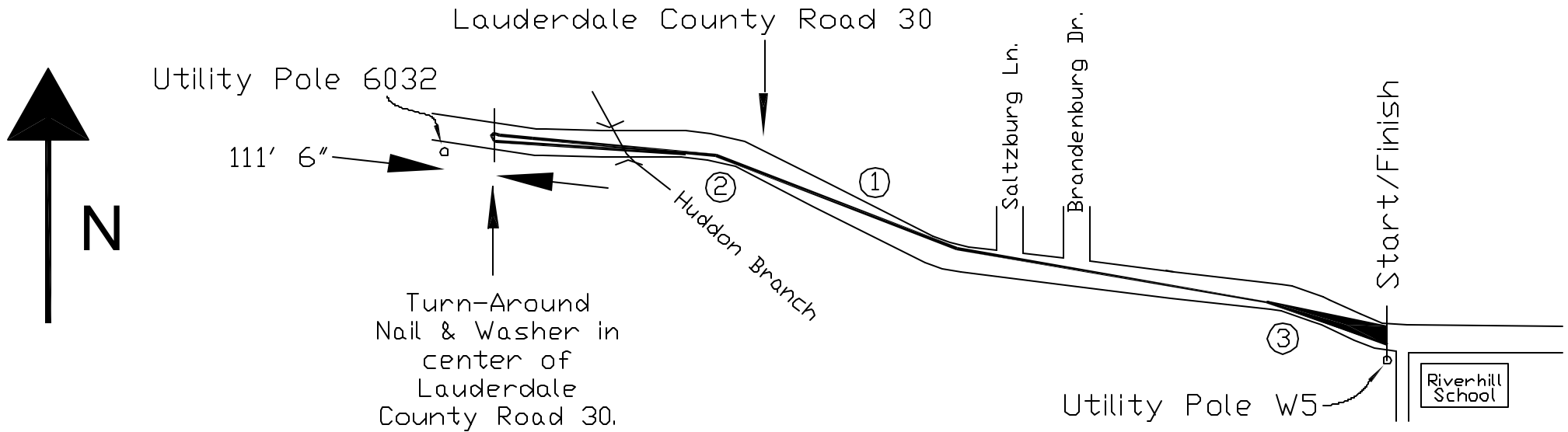

All measurements along Lauderdale County Road 30, also known as Church Road.
 Start/Finish: In line with utility pole W5. Utility pole W5 is first pole west of Riverhill School.
 1 Mile: 85 feet west of a telephone pedestal labeled 2471-W20
 Turn Around: 111 feet, 6 inches east of utility pole 6032
 2 Mile: 159 feet, 9 inches east of utility pole 6029
 3 Mile: 73 feet, 6 inches west of utility pole 6002. Pole is also marked W5.