

Riverhill Run 1 Mile Course
St. Florian, Alabama
Lauderdale County
Measured by Danny Michael and Gary House
April 13, 2003

CERTIFIED AL03015JD

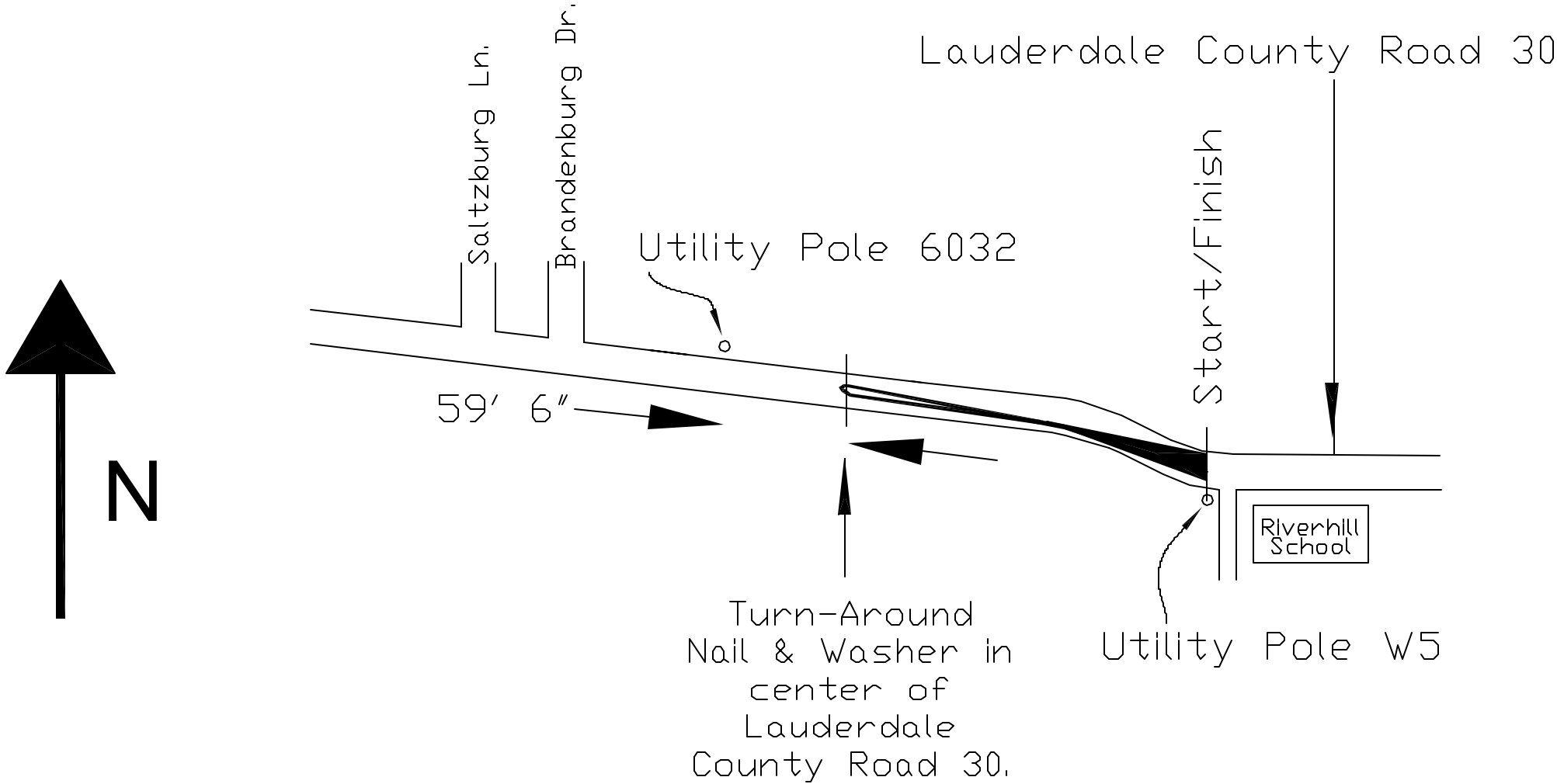

All measurements along Lauderdale County Road 30, also known as Church Road.
Start/Finish: In line with utility pole W5. Utility pole W5 is first pole west of Riverhill School.
Turn Around: 59 feet, 6 inches east of utility pole 2471W15