

# Mayfest 5K Guin, Alabama

Measured by Danny Michael

April 14, 2006

Callbration Course AL03013JD

Map not to scale

NOTE: GPS measurements taken with consumer grade equipment and are listed for reference only. Measurements are subject to the inaccuracies of such equipment.

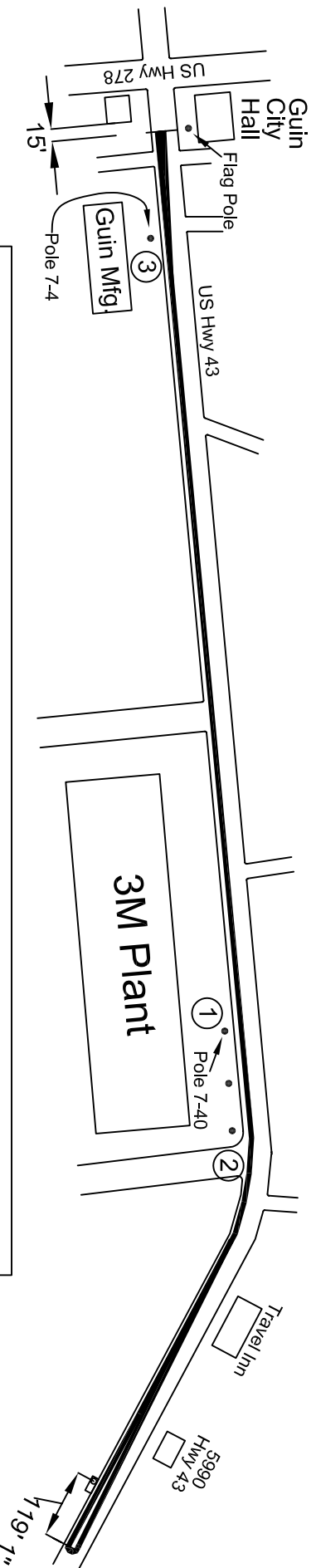

**START / FINISH:** On US Highway 43, aligned with flag pole in front of Guin City Hall. Also measured as 15' east of the east wall of McDonald Signs. N33.96563, W87.91405

**1 MILE:** 38'8" west of utility pole 7-40 in front of 3M plant. N33.96691, W87.89668

**T/A:** 119' 1" east of centerline of manhole cover for curb storm drain. Storm drain is the first drain east of residence at 5990 Highway 43. The residence is the first building to the east of the Travel Inn Motel. N33.96441, W87.88774

**2 MILES:** 102' east of utility pole at west edge of easternmost entrance for the 3M plant. N33.96704, W87.89484

**3 MILES:** 29' east of utility pole 7-4 in front of Guin Manufacturing. N33.96572, W87.91216

All points marked with nail and washer on south side of highway. All references are on south side of highway.