

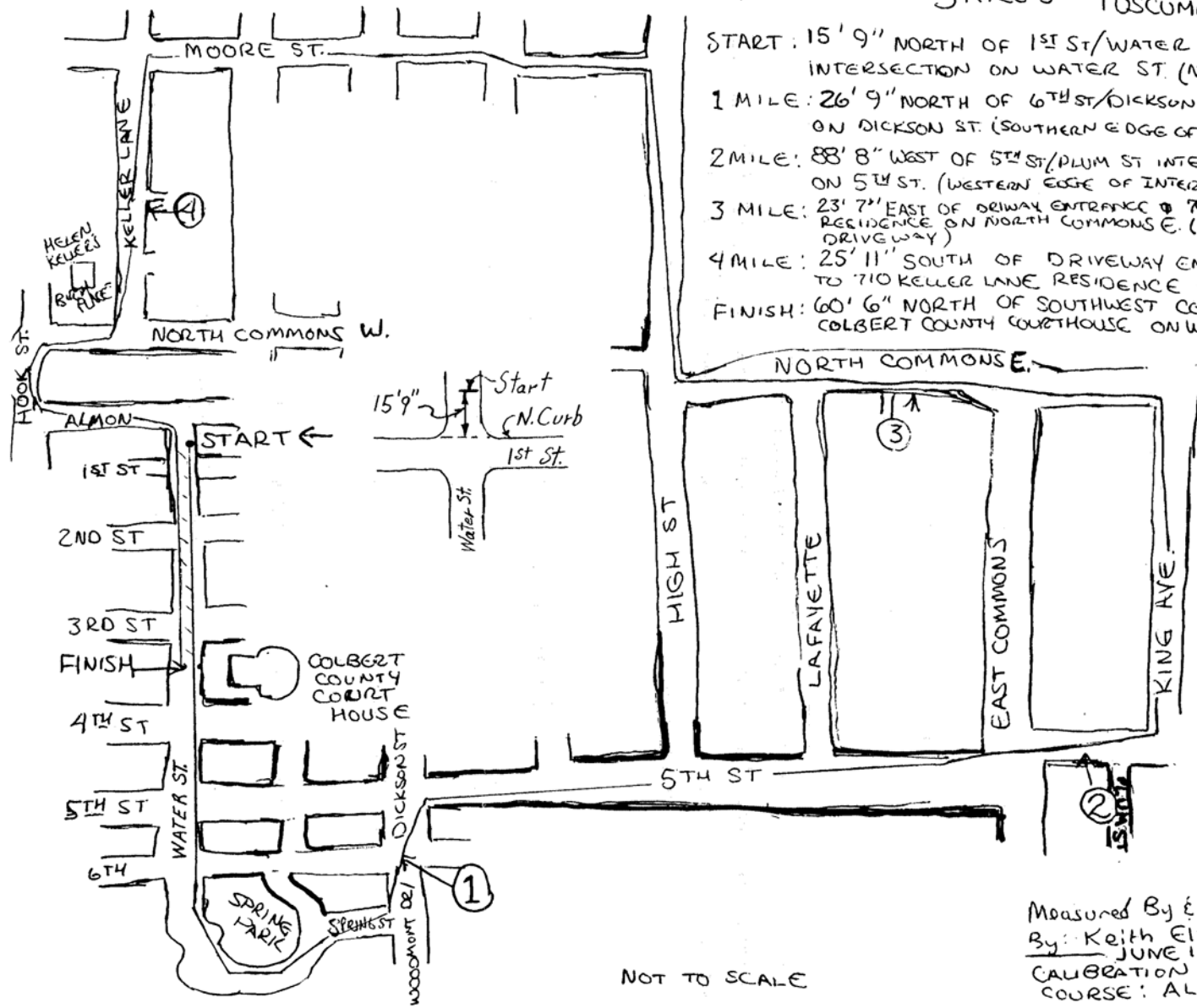

# Helen Keller Festival Run

5 MILES TUSCUMBIA, AL



- START: 15' 9" NORTH OF 1ST ST/WATER ST. INTERSECTION ON WATER ST. (NORTHERN EDGE OF INTERSECTION)
- 1 MILE: 26' 9" NORTH OF 6TH ST/DICKSON ST INTERSECTION ON DICKSON ST. (SOUTHERN EDGE OF INTERSECTION)
- 2 MILE: 88' 8" WEST OF 5TH ST/PLUM ST INTERSECTION ON 5TH ST. (WESTERN EDGE OF INTERSECTION)
- 3 MILE: 23' 7" EAST OF DRIVEWAY ENTRANCE @ 704 NORTH COMMONS E. RESIDENCE ON NORTH COMMONS E. (EASTERN EDGE OF DRIVEWAY)
- 4 MILE: 25' 11" SOUTH OF DRIVEWAY ENTRANCE TO 710 KELLER LANE RESIDENCE ON KELLER LANE
- FINISH: 60' 6" NORTH OF SOUTHWEST CORNER OF COLBERT COUNTY COURTHOUSE ON WATER ST

NOT TO SCALE

Measured By & Map Prepared  
 By: Keith Elliott 256-760-9978  
 JUNE 18, 2001  
 CALIBRATION  
 COURSE: AL90022JD